

RESMED



www.TheCPAPShop.com

Swift™ FX Nano

Swift™ FX Nano for Her

NASAL MASK

User Guide

English



Did you know?

Replacing your mask and supplies is one of the most important steps in maintaining effective therapy



Replace when...

- The cushion is discolored.
- The cushion is cracked, torn or damaged in any way.
- The headgear is stretched and needs to be tightened more than when it was new.
- The short tube is stretched or punctured.



What to do...

Consult your equipment provider to learn what replacement schedule may be available through your insurance policy.



RESMED

Swift™ FX Nano

R_X Only

Swift™ FX Nano for Her

NASAL MASK / MASQUE NASAL / MASCARILLA NASAL /
MÁSCARA NASAL

Fitting / Mise en place / Colocación / Ajuste

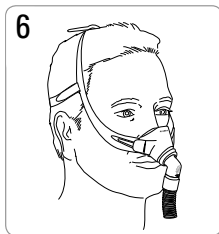
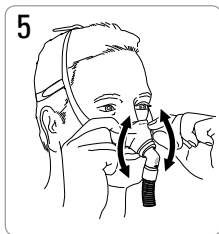
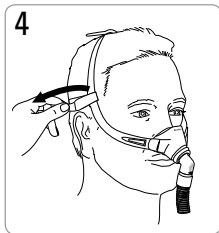
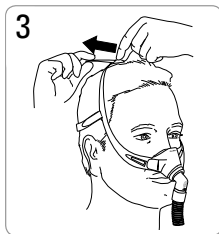
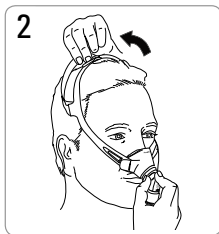
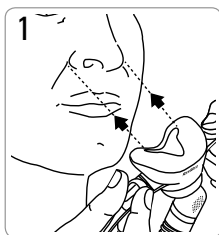

Removal / Retrait / Remoción / Remoção



Disassembly / Démontage / Desmontaje / Desmontagem

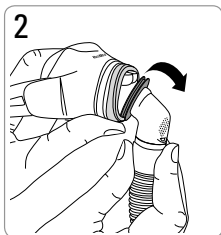
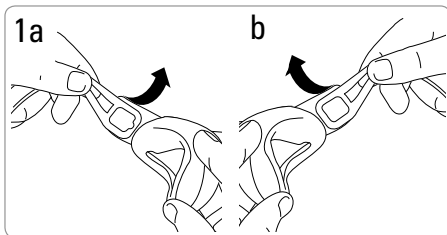

Reassembly / Remontage / Montaje / Remontagem

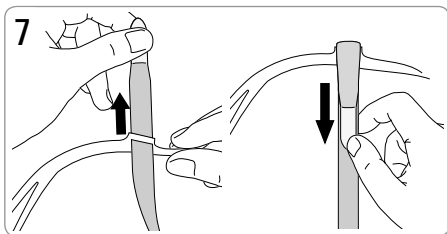
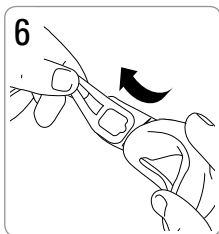
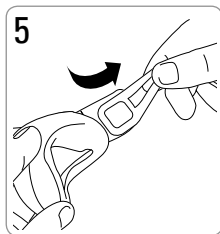
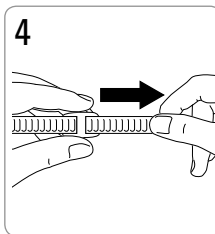
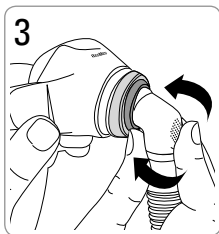
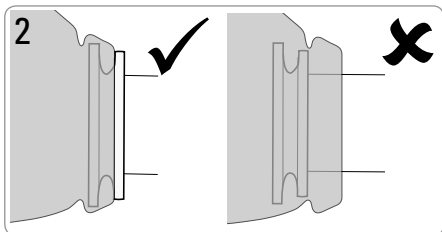
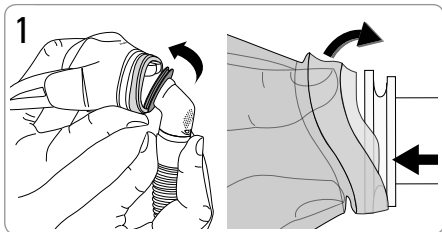

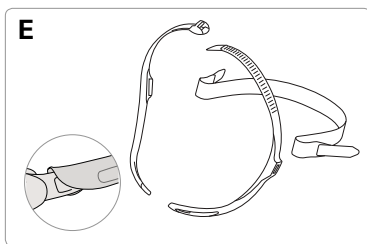
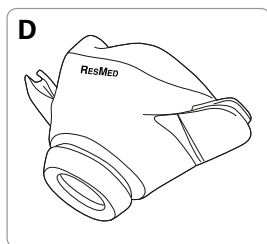
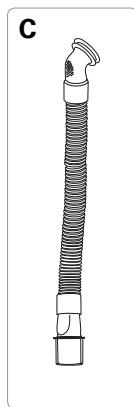
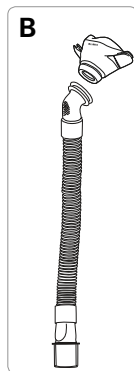
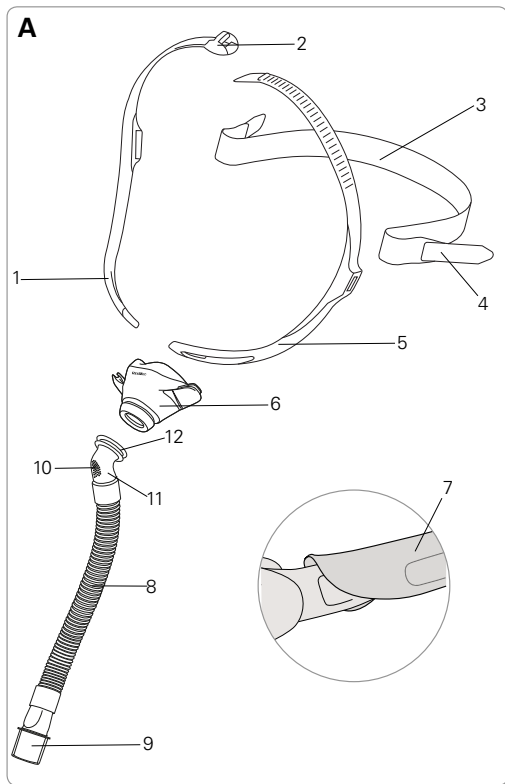

Mask components / Composants du masque / Piezas de la mascarilla / Componentes da máscara

Item / Désignation / Artículo / Item	Description / Description / Descripción / Descrição	Part number / Code produit / Número de peça / N° da peça	
		Swift FX Nano	Swift FX Nano for Her
1	Headgear right / Harnais droit / Arnés derecho / Lateral direita do arnés		
2	Top buckle / Boucle supérieure / Hebilla superior / Fivela superior		
3	Back strap / Sangle arrière / Correa posterior / Correia traseira		
4	Back strap fastener / Attache sangle arrière / Broche de la correa posterior / Fecho da correia traseira		
5	Headgear left / Harnais gauche / Arnés izquierdo / Lateral esquerda do arnés		
6	Mask cushion / Bulle du masque / Almohadilla / Almofada da máscara		
7	Soft wraps / Housses souples / Fundas blandas / Envoltoiros macios	61530 (2 x G)	61544 (2 x P)
8	Short tube / Tuyau court / Tubo corto / Tubo curto		
9	Swivel / Pièce pivotante / Peça giratoria / Peça giratória		

Item / Désignation / Artículo / Item	Description / Description / Descripción / Descrição	Part number / Code produit / Número de peça / N° da peça	
		Swift FX Nano	Swift FX Nano for Her
10	Vent / Orifice de ventilation / Ventilación / Respiradouro		
11	Elbow / Coude / Codo / Cotovelo		
12	Swivel ring / Anneau pivotant / Aro de la pieza giratoria / Anel da peça giratória		
A	Complete system / Système complet / Sistema completo / Sistema completo	62200 (Std) 62251 (W)	62201 (S)
B	Frame system / Entourage complet / Sistema de armazón / Sistema da armação	62220 (Std) 62271 (W)	62221 (S)
C	Short tube assembly / Ensemble tuyau court / Conjunto del tubo corto / Conjunto do tubo curto	62236 (1) 62237 (10)	62244 (1) 62245 (10)
D	Mask cushion / Bulle du masque / Almohadilla / Almofada da máscara	62230 (Std) 62281 (W)	62231 (S)
E	Headgear / Harnais / Arnés / Arnês	62238	62248

S: Small / Petit / Pequeño / Pequeno

Std: Standard / Standard / Estándar / Padrão

W: Wide / Large / Ancho / Largo

G: Gray / Gris / Gris / Cinza

P: Pink / Rose / Rosa / Rosa

Swift™ FX Nano

Swift™ FX Nano for Her

NASAL MASK

Thank you for choosing the Swift FX Nano / Swift FX Nano for Her.
Please read the entire manual before use.

Intended Use

The Swift FX Nano / Swift FX Nano for Her channels airflow noninvasively to a patient from a continuous positive airway pressure (CPAP) or bilevel device.

The Swift FX Nano is:

- to be used by patients >66 lb (30 kg) for whom positive airway pressure has been prescribed
- intended for single-patient re-use in the home environment and multipatient re-use in the hospital/institutional environment.



GENERAL WARNINGS

- The vent holes must be kept clear.
- The mask should only be used with CPAP or bilevel devices recommended by a physician or respiratory therapist.
- The mask should not be used unless the device is turned on.

Once the mask is fitted, ensure the device is blowing air.

Explanation: CPAP and bilevel devices are intended to be used with special masks (or connectors) which have vent holes to allow continuous flow of air out of the mask. When the device is turned on and functioning properly, new air from the device flushes the exhaled air out through the mask vent holes. However, when the device is not operating, insufficient fresh air will be provided through the mask, and the exhaled air may be rebreathed. Rebreathing of exhaled air for longer than several minutes can, in some

circumstances, lead to suffocation. This applies to most models of CPAP or bilevel devices.

- Follow all precautions when using supplemental oxygen.
- Oxygen flow must be turned off when the CPAP or bilevel device is not operating, so that unused oxygen does not accumulate within the device enclosure and create a risk of fire.
- Oxygen supports combustion. Oxygen must not be used while smoking or in the presence of an open flame. Only use oxygen in well ventilated rooms.
- At a fixed rate of supplemental oxygen flow, the inhaled oxygen concentration varies, depending on the pressure settings, patient breathing pattern, mask, point of application and leak rate. This warning applies to most types of CPAP or bilevel devices.
- The technical specifications of the mask are provided for your clinician to check that they are compatible with the CPAP or bilevel device. If used outside specification or if used with incompatible devices, the seal and comfort of the mask may not be effective, optimum therapy may not be achieved, and leak, or variation in the rate of leak, may affect the CPAP or bilevel device function.
- Discontinue using this mask if you have ANY adverse reaction to the use of the mask, and consult your physician or sleep therapist.
- Using a mask may cause tooth, gum or jaw soreness or aggravate an existing dental condition. If symptoms occur, consult your physician or dentist.
- As with all masks, some rebreathing may occur at low CPAP pressures.
- Refer to your CPAP or bilevel device manual for details on settings and operational information.
- Remove all packaging before using the mask.

Using your mask

When using your mask with ResMed CPAP or bilevel devices that have mask setting options, refer to the Technical specifications section in this user guide for mask selection options.

For a full list of compatible devices for this mask, see the Mask/Device Compatibility List on www.resmed.com on the **Products** page under **Service & Support**. If you do not have internet access, please contact your ResMed representative.

Fitting

The fitting illustrations in this user guide show the sequence for obtaining the best fit and comfort when using your mask. A diagram showing the names of parts can be found in the Mask Components diagram near the beginning of this guide.

Fitting steps

1. Ensure that the bottom of the cushion opening is aligned with the bottom of your nose. Place the mask over your nose.
2. Pull the headgear over your head. The buckle on the top strap should sit on top of your head and the fabric back strap should go around the back of your head.
3. Adjust the top strap by pulling the strap through the buckle, one notch at a time. Do not overtighten. The mask should sit comfortably over your nose and the back strap should sit just above your ears.
4. Adjust the fasteners on the fabric back strap until the mask is comfortably sealed. The fabric back strap can be positioned over or under the hair.
5. Adjust the mask cushion until it sits comfortably on your nose.
6. Finally, connect the free end of the short tube assembly to the device air tubing. If the mask leaks, readjust the fabric back strap before the top strap.

Removing your mask

To remove your mask pull the mask and headgear by the fabric back strap up and over your head.

Disassembly

Refer to the disassembly illustrations in this user guide. A diagram showing the names of parts can be found in the Mask Components diagram near the beginning of this guide.

Disassembly steps

1. Remove the headgear by slightly twisting each headgear arm and pulling away from the node on the mask cushion.
2. Peel the mask cushion away from the swivel ring.

Note: *The headgear straps are not intended to be disassembled and can be washed together.*

Reassembly

Refer to the reassembly illustrations in this user guide. A diagram showing the names of parts can be found in the Mask Components diagram near the beginning of this guide.

Reassembly steps

1. Using your forefinger and thumb to stretch the inside of the mask cushion, insert the swivel ring into the mask cushion.
2. Allow the mask cushion to sit in the groove on the swivel ring. The mask cushion is correctly positioned when it is located in the swivel ring groove with no gaps. Ensure that the swivel ring is not pushed all the way into the mask cushion.
3. Rotate the elbow to ensure it moves freely in the swivel ring.
4. Thread the top strap through the top buckle with the notches facing up.
5. Hold the headgear arm with the opening facing you. Latch the headgear arm onto the node on the mask cushion. Make sure that the text on the headgear lines up with the text on the mask cushion.

6. Repeat the previous step with the other headgear arm. Ensure that the headgear straps are not twisted.
7. Thread the fabric back strap through each side of the headgear, then fold over to secure. Ensure that the fastener is on the outside with the ResMed logo facing out.

Cleaning your mask in your home

Your mask and headgear should only be handwashed by gently rubbing in warm (approximately 86°F/30°C) water using mild soap. All components should be rinsed well with drinking quality water and allowed to air dry out of direct sunlight.



WARNING

Do not use aromatic-based solutions or scented oils (eg, eucalyptus or essential oils), bleach, alcohol or products that smell strongly (eg, citrus) to clean any of the mask components. Residual vapours from these solutions can be inhaled if not rinsed thoroughly. They may also damage the mask, causing cracks.



CAUTION

- If any visible deterioration of a system component is apparent (cracking, crazing, tears etc), the component should be discarded and replaced.
- Avoid connecting flexible PVC products (eg, PVC tubing) directly to any part of the mask. Flexible PVC contains elements that can be detrimental to the materials of the mask, and may cause the components to crack or break.

Daily/After each use:

- To optimize the mask seal, facial oils should be removed from the cushion after use.
- Handwash the separated mask components (excluding headgear).

- If the vent or rotating parts such as the swivel, swivel ring or ball joint require cleaning, use a soft bristle brush.

Weekly:

- Handwash the headgear. It may be washed without being disassembled.

Reprocessing the mask between patients

This mask should be reprocessed when used between patients. Cleaning, disinfection and sterilization instructions are available from the ResMed website, www.resmed.com/masks/sterilization/americas. If you do not have internet access, please contact your ResMed representative.

Troubleshooting

Problem/possible cause

Solution

Mask is too noisy.

Vent is blocked or partially blocked.

Elbow inserted incorrectly.

If the vent requires cleaning, use a soft bristle brush.

Remove the elbow from the mask and then reassemble according to the instructions.

Ensure that the swivel ring on the elbow has not been inserted too far into the cushion.

Mask is leaking.

Refit or reposition your mask.

Readjust the back strap to bring the mask closer to the face and improve your seal.

Check that your mask is assembled correctly.

Problem/possible cause	Solution
Mask leaks around face.	
Mask is not positioned correctly.	Check that the ResMed logo is facing upward on the top of the cushion across the bridge of your nose.
Mask may have been fitted incorrectly.	Pull the mask away from your face and reposition, ensuring that the lower corners of the mask fully enclose your nose. If necessary, readjust the top strap to keep the mask in the right place.
Cushion membrane is creased or folded.	Remove and refit your mask according to the fitting instructions. Ensure you position the cushion correctly over your nose before pulling the headgear over your head. Do not slide the mask down your face during fitting as this may lead to folding or curling of the cushion.
Mask is not tightened correctly.	Ensure that the headgear straps are not overtightened or loose. Readjust the back strap to bring the mask closer to the face and improve your seal. Check that the headgear is not twisted.
Mask may be the wrong size.	Talk to your clinician.

Problem/possible cause**Solution****Mask does not fit properly.**

Mask is incorrectly assembled.

Disassemble the mask, then reassemble according to the instructions. Ensure that the swivel ring on the elbow has not been inserted too far into the cushion. Check that the printing on the left headgear strap (Swift FX) aligns to the printing on the cushion arm (Nano).

Mask may be the wrong size.

Talk to your clinician.

Cushion may be dirty.

Clean cushion according to the instructions.

Technical Specifications**Pressure-flow curve**

The mask contains passive venting to protect against rebreathing. As a result of manufacturing variations, the vent flow rate may vary.

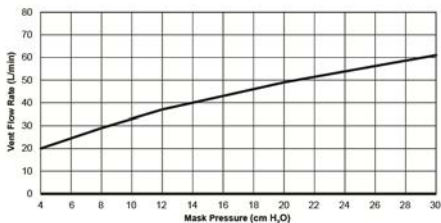

Pressure (cm H ₂ O)	Flow (L/min)
4	20
8	29
12	37
16	43
20	49
22.5	52
30	61

**Dead space
information**

Physical dead space is the empty volume of the mask to the end of the swivel. Using the wide cushions it is 125 mL.

**Therapy
pressure**

4 to 30 cm H₂O

Resistance

Drop in pressure measured (nominal)
at 50 L/min: 0.5 cm H₂O
at 100 L/min: 2.0 cm H₂O

Environmental conditions	Operating temperature: +41°F to +104°F (+5°C to +40°C) Operating humidity: 15% to 95% relative humidity non-condensing Storage and transport temperature: -4°F to +140°F (-20°C to +60°C) Storage and transport humidity: 15% to 95% relative humidity non-condensing
Gross dimensions	Small: 16.9" (H) x 3.94" (W) x 2.95" (D) (430 mm (H) x 100 mm (W) x 75 mm (D)) Standard: 16.9" (H) x 4.09" (W) x 2.95" (D) 430 mm (H) x 104 mm (W) x 75 mm (D) Wide: 16.9" (H) x 4.49" (W) x 2.95" (D) 430 mm (H) x 114 mm (W) x 75 mm (D) Mask fully assembled with short tube assembly (no headgear)
Mask setting options	For S9: Select 'Pillows' For other devices: Select 'SWIFT' (if available), otherwise select 'MIRAGE' as the mask option.













Storage

Ensure that the mask is thoroughly clean and dry before storing it for any length of time. Store the mask in a dry place out of direct sunlight.

Disposal

This mask does not contain any hazardous substances and may be disposed of with your normal household refuse.

Symbols

 Read instructions before use;  Batch code;
 Catalogue number;  Temperature limitation;  Humidity
limitation;  Does not contain natural latex rubber;  Manufacturer;
 Indicates a Warning or Caution and alerts you to a possible injury or
explains special measures for the safe and effective use of the device;
 Keep away from rain;  This way up;  Fragile, handle with care;
 Prescription only (In the US, Federal law restricts these devices to
sale by or on the order of a physician.);  European Authorized
Representative

Limited warranty

ResMed Ltd (hereafter 'ResMed') warrants that your ResMed mask system (including mask frame, cushion, headgear and tubing) shall be free from defects in material and workmanship from the date of purchase for the period of 90 days or in the case of disposable masks the maximum use period. This warranty is only available to the initial consumer. It is not transferable. If the product fails under conditions of normal use, ResMed will repair or replace, at its option, the defective product or any of its components. This limited warranty does not cover: a) any damage caused as a result of improper use, abuse, modification or alteration of the product; b) repairs carried out by any service organization that has not been expressly authorized by ResMed to perform such repairs; and c) any damage or contamination due to cigarette, pipe, cigar or other smoke. Warranty is void on product sold, or resold, outside the region of original purchase.

Warranty claims on defective product must be made by the initial consumer at the point of purchase.

This warranty replaces all other expressed or implied warranties, including any implied warranty of merchantability or fitness for a particular purpose. Some regions or states do not allow limitations on how long an implied warranty lasts, so the above limitation may not apply to you.

ResMed shall not be responsible for any incidental or consequential damages claimed to have resulted from the sale, installation or use of any ResMed product. Some regions or states do not allow the exclusion or limitation of incidental or consequential damages, so the above limitation may not apply to you. This warranty gives you specific legal rights, and you may also have other rights which vary from region to region. For further information on your warranty rights, contact your local ResMed dealer or ResMed office.

**Manufacturer:**

ResMed Ltd 1 Elizabeth Macarthur Drive Bella Vista NSW 2153 Australia

Distributed by:

ResMed Corp 9001 Spectrum Center Boulevard San Diego CA 92123 USA



ResMed (UK) Ltd 96 Milton Park Abingdon Oxfordshire OX14 4RY UK

See www.resmed.com for other ResMed locations worldwide.

For patent information, see www.resmed.com/ip

Swift is a trademark of ResMed Ltd and is registered in U.S. Patent and Trademark Office. Velcro is a trademark of Velcro Industries B.V.



Swift™ FX Nano for Her
NASAL MASK



628034/4 2013-01

Swift FX Nano /
Swift FX Nano for Her

USER

AMER ENG



628034

Swift™ FX Nano
NASAL MASK